



OFFICE OF THE REGISTRAR
DIBRUGARH UNIVERSITY
Dibrugarh | PIN - 786 004 | Assam

No: DU/RP/PMC/2020/295

Date : 13/10/2020

:: Short Notice Inviting Quotation ::

Sealed Quotations are invited from reputed manufactures/authorized dealers/suppliers for setting up of **Laboratory** at the Department of Physics, with furniture of Godrej or equivalent make under the **RUSA 2.0**. Detailed specification of the items, terms & conditions etc are given below. **Last date of submission of Tender as per annexure with all relevant papers is 20/10/2020 up-to 16:00 hrs.**

Availability of Bid papers On website- https://dibru.ac.in/tender/	From: 13/10/2020 (17:00 hours) To: 20/10/2020 (upto 16:00 hours)
Time & Date of opening of Technical Bid	21/10/2020 at 11:00 hours
Cost of the Document	₹500/- (non refundable)
Place of opening of Bid	Office of the Registrar, DU
EMD	2% of the bid amount

The tender should be submitted in two separate sealed envelopes *i. e.* **Part - I** : TECHNICAL BID and **Part - II** : FINANCIAL BID. The technical bid shall be opened on above mentioned date and time and the financial bid of only those bidders who qualify in technical bid shall be opened on the same date or at a later date which shall be intimated to the tenderer whose technical bid are found to be valid. Dibrugarh University reserves all the rights to reject any or all the tenders without assigning any reason thereof. Details may be seen at <https://dibru.ac.in/tender/>

Sd/-
Registrar
Dibrugarh University
Dibrugarh University

Copy to:

1. The Hon'ble Vice Chancellor for favour of information .
2. HOD, Deptt. of Physics. Sciences for information.
3. The Deputy Registrar (F&A), D.U. for information.
4. Dibrugarh University Website
5. Office File

Sd/-
Registrar
Dibrugarh University
Dibrugarh University

CUT-OUT SLIP

NAME OF THE WORK: Setting up of **Laboratory** at the Department of Physics
under RUSA 2.0

NIQ NO. : DU/RP/PMC/2020/295

Date: 13/10/2020

SUBMISSION DUE DATE & TIME

: 20/10/2020 up-to 16:00 HOURS.

FROM:

TO:

NAME:
ADDRESS

THE REGISTRAR
DIBRUGARH UNIVERSITY
DIBRUGARH, ASSAM

(To be pasted on the outer envelope containing “Technical” & “Commercial” bids)

Part A - Terms and Conditions

Part B - Specifications

PART A - TERMS AND CONDITIONS

GENERAL INFORMATION

The bids duly complete in all aspects, along with the necessary supporting documents should be submitted to the Registrar, Dibrugarh University. The Financial bids of the Bidders shall be opened on the same date or at a later date to be intimated to the tenderers whose Technical Bids are found to be valid.

I. Instructions to the intending bidders:

1. The intending bidders should read carefully all the instructions and terms and conditions, etc before quoting rates in prescribed schedule of this Bid Document. Taxes and duties etc. should be shown separately.
2. All the manufacturers/ distributors/ stockiest should also give a brief profile about their company and the facilities available with them of the quoted items. Their turnover and important firms/ Government Institutes/ P.S.U.s etc. to which they are supplying quoted items, should also be mentioned.
3. The rates in Indian Rupees should be mentioned in the **Schedule** attached with this Bid Document. Each page of the Bid shall be signed in full and stamped with the seal of the supplier. The signatory/ies to the document must clearly state in what capacity he or she is signing the Bid Document.
4. The intending bidder shall submit the bids in two envelopes. The first envelope (Technical Bid) shall contain all the documents referred to in **Para- III below** and be sealed. The second envelope (Commercial Bid) shall contain the **Schedule**, in which the bidder shall quote the rates of supply. The second envelope shall also, likewise, be sealed. Both the envelope then should be put together, and should be sealed in one envelope on which the cut out slip provided as part of the Bid document should be pasted, and the particulars shall be duly filled in. The Technical Bid shall be opened first to ensure that suppliers have submitted all the requisite documents. If the Technical Bids are not in order or any deviations encountered in some aspect, the commercial bids of such bidder/s shall not be taken into consideration.
5. The data sheet documents, technical documents, etc (if any) submitted should be available at any time on the website of the respective manufacturer / OEM and URLs to the respective documentation should be provided in the compliance statement for verification and future reference.
6. The bidder must avoid incorporation of ambiguities on any point on the bid documents. All points should be clear and to the point.
7. Application fee and EMD to be submitted through Demand Draft or A/C payee Cheque individually to be drawn in favor of **“Registrar, Dibrugarh University”**.

II. General Terms and Conditions :-

1. Technical specifications of the instruments/equipment are given in **Annexure** to these papers (Part B).
2. The delivery and installation should be completed within 45 (forty-five) days or as specified from placing of the order. No extension shall be granted to the contractors/suppliers for the period of delivery, under any circumstances.
3. If the supplier fails to deliver the article as per the delivery schedule, the University shall be free to procure the balance/undelivered supply, at the risk and cost of the supplier, from other such suppliers.
4. The goods, articles, materials supplied by the supplier shall be accepted after inspection by an officer authorized by the competent authority. No articles/materials which do not conform to the specifications laid down in the terms and conditions or damaged in transit shall be accepted.
5. The bills of the suppliers shall be paid by the University after all the materials/articles/equipment along with requisite parts/accessories have been received and installed, inspected and commissioned.
6. The bidder may also indicate details of any accessories/spare items that may form part of the said equipment.
7. The price quoted on the Bid should be F.O.R. Dibrugarh University and shall have to be valid for atleast 60 days. Further, this Bid document is not transferable.
8. In the event of any breach of the terms and conditions of the supply, the University may terminate the contract placed with the supplier and forfeit the security deposit of the supplier.
9. The quantity as mentioned at Part-B (Specifications) are indicative and not exhaustive. Actual requirement may be varied at the time of placing Order as per requirement.
10. Exemption from submission of Bid Security (also known as Earnest Money) is allowed to Micro and Small Enterprises (MSEs) as defined in MSE Procurement Policy issued by Department of Micro, Small and Medium Enterprises (MSME) or are registered with the Central Purchase Organisation or the concerned Ministry or Department.
11. **Refund of EMD:** - The eligible shortlisted L1 vendor shall be entitled for refund of EMD after one year from the date of satisfactory completion of supply, installation, commission etc. All other bidders shall be entitled for refund, within one month from the date of confirmation of the L1 bidder by the Competent Authority.
12. The shortlisted bidder must address all the technical glitches as and when encountered by the end user or their authorised representative for atleast 06 (six) months from the date of installation without any additional cost.
13. The bidder must also illustrate the quoted item with diagram/prototypes/detailed dimensions etc. for better understandability of the evaluators and higher probability of consideration.

III. Terms and Conditions regarding Documentation:-

1. Vendor must submit duly signed Compliance statement in tabular form comparing each specification of the quoted item with that given in the Bid Document **Part - B**.
2. Suppliers shall submit the following documents along with their quotations:
 - a) Certificate of Incorporation/Registration
 - b) PAN/GST Registration Certificate.
 - c) Technical specifications offered by the Supplier.
 - d) Technical compliance table.
 - e) Technical literature regarding the offered products including diagrams/prototypes.
 - f) MSME Registration Certificate (if applicable) for availing EMD exemption.
3. The Bidder shall have to be an Original Equipment Manufacturer (OEM) or his Authorized Dealer/Channel Partner having a Direct Purchase and Support agreement with the OEM. In case, the Bidder is a Dealer, a valid LETTER OF AUTHORIZATION from Original Equipment Manufacturer should be produced along with the bid.

Note:

- (a) No erasures or overwriting shall be allowed, unless they are authenticated under the full signature and the seal of the tenderer.
- (b) The University reserves the right to:
 - (i) Accept/reject any/all tenders without assigning any reason thereof.
 - (ii) Revise the quantities at the time of placing the order without change in the rate quoted by the bidder.
 - (iii) Add/modify/relax or waive any of the conditions stipulated in the Bid document whenever deemed necessary.
 - (iv) Award the contract to one or more bidders for the items covered by the Bid document.
 - (v) Accept ambiguity (if any) incorporated on the bid, in the manner so favorable/beneficial to the University.
- (c) Participating in the NIQ shall imply unconditional acceptance of all the terms and conditions mentioned in the bid document.

Schedule of Rates

ITEM No	DESCRIPTION OF GOODS WITH DETAILS OF SPECIFICATIONS	Make	Unit Price (INR)	Taxes	Qty.	Total Amount (INR)
1						
2						
3						
Gross Total (₹)						

Signature of the Bidder
Seal of the Firm

***Add/remove rows as per requirement.
***Addition/removal of columns is not permitted.

Part – B

Specifications of the items for setting up of Laboratory

MANDATORY REQUIREMENTS

1. The bidder should be a manufacturer registered in India or their authorized dealer or should be 100% subsidiary in India of parent company, if any
2. Joint ventures shall not be considered.
3. The bidder should have had an Office nearest to the University for the last 7 years for faster and better serviceability.
4. If an authorized dealer is bidding for the parent company then the authorized representative should be having an office for the last 5 years
5. Should have satisfactorily completed installation of laboratory furniture works in Assam only as mentioned below during the last Seven years “Similar work” shall mean Lab furniture comprising of fume hoods, lab work benches, electrical, LAN, gas & utility distribution, etc.

Required: Documentary Evidence

6. SEFA Membership Certificates for Last four years on a continuous basis
7. **Membership Certificate:** The bidder/parent company should possess the key professional staff, at least one, in his organization with good knowledge of codes and standards like SEFA, OSHA, EN 14175, ASHRAE 110 and NFPA 45. Such professionals should have a valid membership of SEFA and in addition membership of any of the international governing standards.
8. ISO 9001-2008, ISO 14001-2004, BS OSHAS 18001-2007 (For Design, Development, Manufacturing, Supply and servicing)

LABORATORY FURNITURE

Scope of Work

- Supply and Installation of Laboratory Workbenches/Storage units including granite worktops and other supporting structures/hardware's based on the specified Make List. This includes delivery to Dibrugarh University, unloading the consignment and transporting it from the place of storage to the installation site.
- Supply & Installation of all utility service outlets and accessory fittings, electrical receptacles, plumbing and electrical switches & fittings identified on drawings as mounted on the laboratory furniture.
- Supply & Installation of all laboratory sinks, bottle traps, drain troughs etc.
- Supply & Installation of service structures where specified and setting in place reagent shelves of the type shown in the drawings.
- Removal of debris, dirt and rubbish accumulated as a result of installation/commissioning of the laboratory furniture and accessories and leaving the premises broom clean and orderly.

Basis of Work

- It is the intent of this specification to use specified make list as the standard of construction for steel laboratory furniture. The construction standards of this product line shall provide the basis for quality and functional installation.

Quality Assurance

- The steel laboratory furniture manufacturer shall provide work tops and casework all manufactured & shipped with proper packing & should take the full responsibility of the entire Scope of Works as specified in the tender.
- General Performance: Furniture shall meet the performance requirements and should follow SEFA 8 guidelines

Submittals

- Manufacturer's Data: Submit installation instructions for each type of casework.
- Samples: Samples if called for will be reviewed for color, texture, and pattern only.
- Shop Drawings – Submit shop drawings for furniture assemblies showing the required details.

Products/Manufacturers

- The selected bidder must warrant for a period of one-year starting (date of acceptance or occupancy, whichever comes first that all products sold under the contract referenced above shall be free from defects in material and workmanship.

TECHNICAL SPECIFICATIONS OF NUCLEUS SYSTEM

D-FRAME SYSTEM

All D-Frames assemblies should be manufactured from standard hollow metal sections; confirming to I.S. Code 7138:1973 (Indian Standard specification for steel tubes for furniture) and all sheet metal components should be of CRCA confirming to IS Code 513:1994.

The suspended under-bench welded units should be supported on heavy-duty steel frames fully carrying the load of worktops. Its superior strength combined with aesthetically appealing end caps shall give maximum flexibility and modularity while making a layout. D-frame should be constructed from a rectangular pipe with a cross section of 30mm x 30mm and should be a minimum 1.6 mm thick. The D-frame legs should be supplied with adjustable feet (tolerance from -5mm to +20mm) to correct the unevenness of flooring. The tubular enclosed type construction shall discourage dust accumulation and unwanted development of bacteria & fungus.

Drainage gradient should be well adjusted throughout the length of table and should have horizontal supports for drainage systems... It should be suitable for sitting and standing nominal heights of 750mm & 900mm respectively. The nominal table depths should be 450mm, 600mm, 750mm for wall side and 1050mm, 1200mm, 1500mm for Island tables. The Corner Units shall fit well with 770mm & 920mm table depths. All frame-work is should be pre-treated with superior pure epoxy powder coated finish.

The D-Frames should be for suspended storage cabinets

HORIZONTAL MEMBERS

These should be made from rectangular pipes of 2mm thickness. Cross-sectional dimensions of the pipe should be 30 x 30mm with a minimum of 1.6 mm. They should be made of CRCA MS and coated with pure epoxy powder. These connect two D-Frames together as shown using C-clamps/U-clamps. Together with the D-Frames and Horizontal Members connected together, the skeletal structure of the work-bench is formed on which the worktop can be placed and the hanging-type storage cabinets can be suspended. Horizontal Members determine the width of the lab workbench as they form the member (distance)

between two adjacent D-Frames. They should be available in various widths of 450,600, 900, 1050, 1200, 1350, 1500, 1650, and 1800

COVER PANELS

All side cover panels and back panels, filler panels should be made from CRCA MS panels of minimum 0.8mm thickness with pure epoxy powder coating.

Dropper:

Uptotable top. 115X45 with minimum thickness of 0.8mm

VERTICAL UPRIGHT (reagent shelf post):

The Upright system will form the back-bone for internal distribution of GDS, Electrical supply systems Shelves and Top Units and should be constructed from 1.2mm CRCA formed steel panels with removable covers.

REAGENT SHELVES

Fixed-Type reagent shelves should be provided. It should be complete modular design consisting of 2 stage horizontal storage shelves made of minimum 1.2 mm thick frame. CRCA MS with pure epoxy powder coating and having cutouts for electrical switches and sockets. It should have provision for placing Granite pieces.

ELECTRICAL TRUNKING

Used for housing electrical switches and sockets, data and voice points, its top panel, bottom panel of the trunking should be made from minimum of 0.8mm thick body. It should be available in both, single sided and double sided configurations. It should be made from CRCA MS with pure epoxy powder coating. The front surface that houses the electrical points should have a slope

WELDED UNDER-BENCH STORAGE CABINETS

Under bench cabinets are Pure epoxy powder coated with thickness of 40-60 microns and are suspended from tubular structure, with an overlay shutter. The cabinet has a corrosion resistance magnetic strip as shutter catch ,shutter and drawer are equipped with 180 degree cam lock. Semi recessed handle and SS-304 five knuckle overlay hinge with 270 degree opening

Unit Construction: Welded body with load bearing members such as top, bottom and stiffeners should have a minimum thickness of 0.8mm and drawer separator is 1.2mm thick.

Shelf: is made of 0.8mm thickness which is adjustable to 6 steps of 50mm.Shutter is over-closing with 270 degree opening. It has a sandwich construction with profile as a sound dampner.

Drawer: Welded filled with profile as sound dampner Single piece construction with an over closing drawer.

WELDED OVER-HEAD STORAGE CABINETS

Under bench cabinets are Pure epoxy powder coated with thickness of 40-60 microns and are suspended from tubular structure, with an overlay shutter. The cabinet has a corrosion resistance magnetic strip as shutyter catch, shutter and drawer are equipped with 180 degree cam lock. Semi recessed handle and SS-304 five knuckle overlay hinge with 270 degree opening

Unit Construction: Welded body with load bearing members such as top ,bottom and stiffeners are of minimum 0.8mm thickness and drawer separator is 1.2mm thick.

Shelf: is made of 0.8mm thickness which is adjustable to 6 steps of 50mm.Shutter is over-closing with 270 degree opening. It has a sandwich construction with profile as a sound dampner.

SERVICE FITTINGS AND ACCESSORIES

Service fittings should be laboratory grade, and water faucets and valve bodies should be cast red brass alloy or bronze forgings, all fittings should be powder plated unless specified otherwise.

Service Indexes: Fittings should be identified with service indexes in the color coding as per DIN 12920.

ELECTRICAL TRUNKING

Made of single piece body, with over closing cover fitted with 2 nos 16A switch and sockets. Telephone jack and computer data transfer socket. Cover is of 1.2mm thickness. Bottom plate works as separate between body and worktop and helps in preventing rusting of body, made from 6mm thick PP sheet.

LABORATORY SINK AND ACCESSORIES

Polypropylene Molded Sinks: Made up of 5 mm thick high density and elastic poly propylene with good resistance to organic solvents. Standard bowl size (L x W x D) is 500 x 400 x 300 mm. Faucet should be 1-way type faucet of approved make

BALANCE TABLE

The table consists of following parts:

Tubular frame - Completely modular type tubular frame, which carries the load of kadappa and granite, kept on it. High-tension Pan head M6 Zinc black-coated screws (for better corrosion resistance) are used for the fastening. The material used is: 40Sq x 1.6 mm thick ERW tube and the overall load carrying capacity of tubular frame is 250 kgs of uniform distributed load.

Cover Panels – They are 0.8 mm thick CRCA MS sheet and pre-treated and epoxy powder coated for better corrosion resistance. The thickness of powder coat is 45-50 microns which passes the test of Salt Spray for 1000 Hours and having the Scratch Hardness of 3 Kgs.

Kadappa - 25mm thick Kadappa acts as the shock-dampening component.

Work Surface – granite

Vibration Isolating Rubber pads - The objective of using these rubber pads is to absorb the pulsating vibrations coming from the floor. The pads are made up from combination of nitrite rubber, cork particles and cross linked polyester fiber. This high-grade compound material possesses all the physical and mechanical properties required to minimize the dampening effect.

Levelling screws - The Tubular frame has the provision for 4 height adjusters or Levelling Screws that take care of all levelling aspects.

Size: (Width: 600/900mm, Depth: 600mm, Height: 750/900mm)

CHEMICAL STORAGE CABINETS

It is used for storages of corrosive chemicals and is provided with a ventilation system to enable exhaust of localized fumes emanating from the chemicals stored. The material should be is 1.2 mm CRCA MS with pure Epoxy Powder coating. It must be fitted with a float glass to enable visibility inside the cabinet. It should also has louvers/perforations for air supply. The overall dimensions are 1000 x 486 x 1800 mm (W x D x H)

PEG BOARDS

These should be Single faced high grade stainless steel pegboard having a tray hole for water drainage and detachable pegs. The essence should be made up of I mm thick stainless steel (SS 304) whereas the pegs should be made up of polypropylene and should be adjustable with a minimum 10mm distance between each peg

WORKTOP

It should be 16mm (+/- 2mm) thick Jet Black Granite worktop. The exposed edges of the worktop should be chamfered and smoothed. The bottom of the worktop should be polished and there should be a V-groove throughout the length of the exposed edges to protect the cabinets from coming in contact with the spillages. The overhang on the storage cabinet is 25 mm at the front side and 30 mm at the sides. The backing material used is a neoprene mat of 6 mm thickness. A representation the worktop edges is shown as under

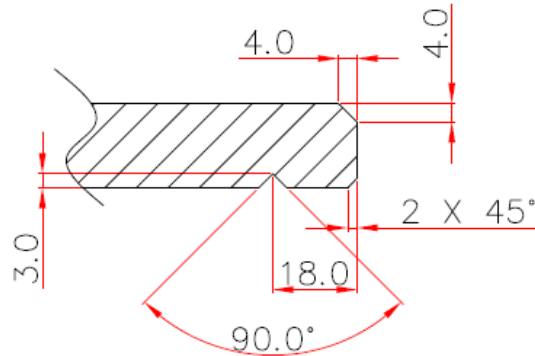

EMERGENCY SHOWER AND EYEWASH

GENERAL - Provide emergency eye, eye/face wash, safety stations and drench hose units with spray-type outlet heads to deliver a soft, wide, high volume spray of water. Outlet heads should have an internal self-regulating flow control, a reticulated polyurethane filter, a threaded spray cover and a hinged swing-away dust cover. Hinged cover should be permanently attached to outlet head body with a stainless steel pin. All wearing components should be located inside spray head for ease of service. All emergency eye wash and shower equipment should be third-party certified to comply with ANSI Z358.1-2009.

DECK-MOUNTED EYE-WASH - Deck mounted drench hose units should have a single outlet head with a rubber protective collar and should deliver an aerated flow of water. The valve should be forged brass self-closing type with a stainless steel squeeze handle. Units should be furnished with a deck flange and an 8 ft. reinforced PVC hose

FLOOR BASED PVC EMERGENCY SHOWER CUM EYE-WASH -Corrosion resistant, combination eye wash/shower safety station with ABS plastic shower head, ABS plastic bowl, cast aluminum powder coated flag handle, PVC floor flange, 2" IPS Schedule 80 PVC pipe and fittings, 1" IPS and 1/2" IPS U.S. made PVC coated brass stay open ball valves, and polished stainless steel pull rod. Unit shall have (2) polypropylene spray heads with integral dust covers, filters, and 1.8-GPM flow control orifices mounted on a PVC coated brass head assembly. Unit shall include ANSI compliant sign

SPOT EXTRACTORS

General description - Extractor arms mainly for use in chemical environments, where an extended resistance against chemical substances is a demand. All aluminium parts should have a double anodized surface protection

Arm sections - Thin walled anodized aluminium sections with a very good corrosion resistance.

Swivel - Swivel with 360 degree rotation. Add reduction for correct connection diameter.

Joints - The adjustment knobs on the friction joints should be supported by ball-bearings. The first joint should be supported by a spring (not Ø100-1200). 360 degree rotation where indicated.

Mini hood - The Mini hood should be supplied together with the arm and is also interface to the multi-purpose and metal hood.

Mounting - The arms can be mounted on ceilings, walls and floors or fixed to tables. By using an extension profile the arm's operational reach must be increased.

Other – All the arms should be provided with dampers, tight down to an under pressure of 3500 Pa. Air temperature -10 °C to 70 °C. Material recovery: 99% by weight.

Components to be provided: Spot Extractor arm, Bracket for Spot Fume Extractor, Multi-purpose hood (380mm x 460mm), Aluminium Extension Profile 1100mm Length, Reducer 75-80 FR Spot Fume

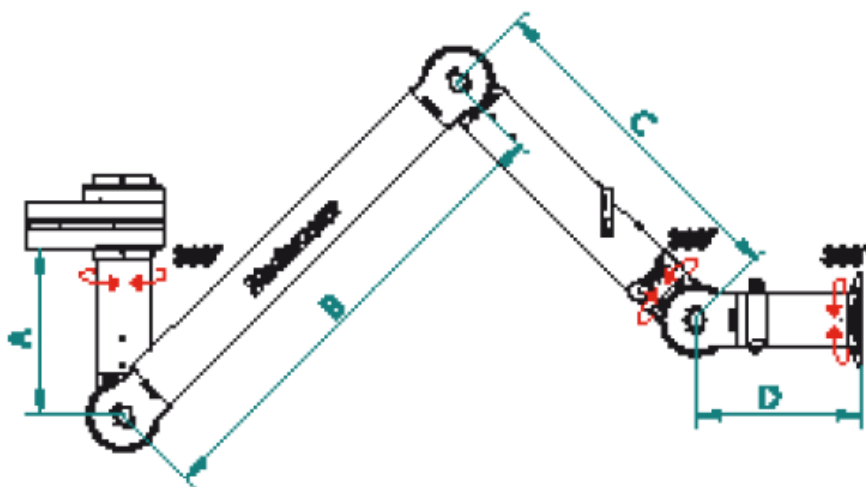

DIMENSIONS:-

Connection Direction	Diameter (mm)	A (mm)	B (mm)	C (mm)	D (mm)	Length (mm)
Up	75	250	700	500	250	1500

MATERIALS:

Flange	PP
Tubes	Aluminium, surface HM-White
Joints	PP with glass fibre reinforcement
Plastic rings	PP with glass fibre reinforcement
Axial locking rings	PP with glass fibre reinforcement
Adjustment knobs	PP with glass fibre reinforcement screws in stainless steel
Threaded shaft inside joints	Stainless steel
Damper blade	Thermo Plastic Elastomer
Damper adjustment handle	Aluminium, anodized
Internal spring	Stainless steel
Bearings swivel	PP with glass fibre reinforcement
Swivel	Aluminium
Rivets	Stainless steel

Recommended airflows

Ø 50	50-110 m ³ /h
Ø 75	110-240 m ³ /h
Ø 100	200-450 m ³ /h

Sd/-

Registrar

Dibrugarh University

Dibrugarh University

Checklist of Documents

The Checklist should be accompanied along with the technical bid.

Sl no	Document	Instrument No (Wherever applicable)	Check
1	Application Fee (If applicable)		<input type="checkbox"/>
2	EMD		<input type="checkbox"/>
3	Technical Compliance Statement		<input type="checkbox"/>
4	Certificate of OEM/Authorisation letter		<input type="checkbox"/>
5	Certificate of Incorporation/Registration		<input type="checkbox"/>
6	PAN/GST Registration No		<input type="checkbox"/>
7	MSME Registration Certificate (if applicable) for availing EMD exemption.		<input type="checkbox"/>

*** Any other supporting documents as felt necessary by the bidder may be enclosed

Signature of the Bidder
Seal of the Firm

Technical Compliance Statement

Sl no	Item	Reqd Qty	Compliance	Deviation (if any)
1				
2				
3				

Signature:

Date.....

Name :.....

Address :.....

.....

.....

Mobile No.....

***Add/remove rows as per requirement.

***Addition/removal of columns is not permitted.